

Signia Assistant

SIGNIA ASSISTANT

# YOUR VERY OWN HEARING COMPANION

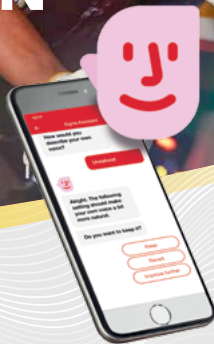

[signia-hearing.com/signia-assistant](http://signia-hearing.com/signia-assistant)

**signia**

Life sounds brilliant.



## A HIGHLY INTELLIGENT ASSISTANT

The new Signia Assistant is your very own hearing companion to let you stay fully involved in life and hear what matters to you.

As the world's first neural network for hearing aids, the Signia Assistant is inspired by the way the human brain solves challenges. Similar to how the brain's neurons create new connections to learn new skills and acquire knowledge, the Assistant continually gains new insights to give you the most personalized hearing experience possible.

### The Signia Assistant gives you:

- **Settings tailored to your personal preferences** for an even clearer sound and best speech comprehension in every situation
- **Answers to your questions** about how to handle your hearing aids
- **Highly intuitive 24/7 support** whenever you need it
- **Confidence and control** over your hearing success



**All you need** to get started with the Signia Assistant:

- Your Bluetooth-enabled Signia Xperience hearing aids
- The Signia app on your smartphone



# THE SIGNIA ASSISTANT LIVES IN THE SIGNIA APP



In the Signia app you have two types of control:

- 1. Traditional remote control** with on-the-go changes to volume and sound balance for temporary changes, which are reset when you turn off your hearing aids;
- 2. The Signia Assistant** for tailored adjustments to help you find your perfect sound. Changes remain even after you switch off your hearing aids.

The Signia app is compatible with Android and iOS. Downloading it from the Apple App Store or Google Play Store is free of charge.



# How to get started with the Signia Assistant



When opening the Signia app, the Signia Assistant's face appears at the top right of your screen

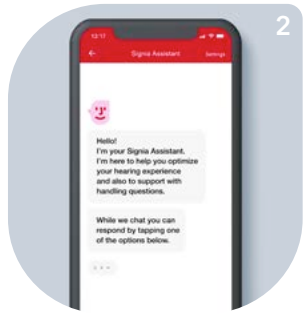

Simply click on it and the Signia Assistant will welcome you and ask how it can help

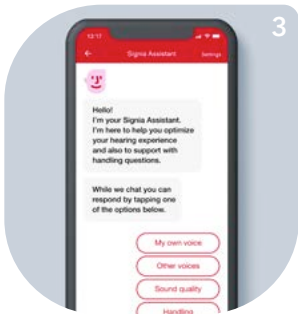

Choose from a list of options to address your need

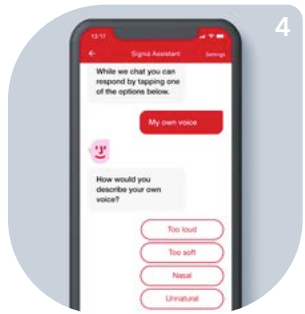

Continue to answer the Signia Assistant's questions



8 out of 10 people would recommend trying hearing aids with the Signia Assistant to a friend.\*

\* Data on file

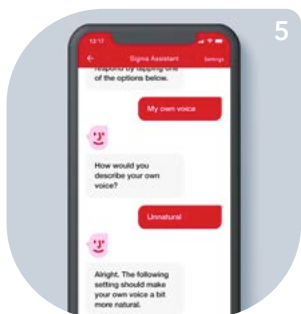

Based on your answers, the Assistant suggests instant sound improvements for you

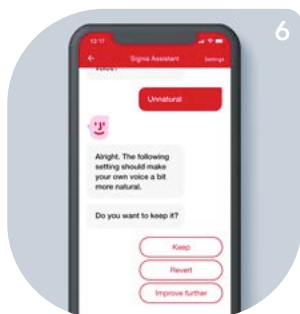

You can: keep the new settings, revert, or keep improving them further

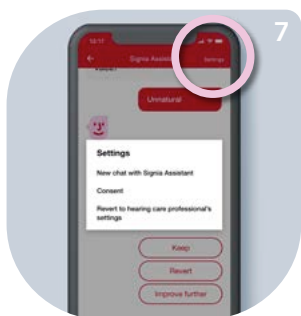

Under "Settings" you can start a new chat, learn about our data policy and revert from your current settings to the hearing care professional's settings

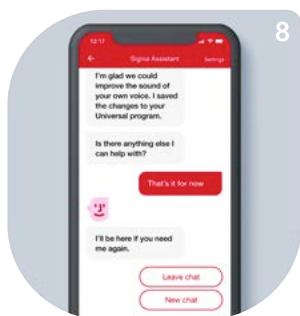

You also have the possibility to start a new chat after you finish a dialogue with the Signia Assistant

The same steps apply when you have handling questions.



93% of wearers say the Signia Assistant boosts their confidence to rely on their hearing aids and lets them feel more in control of their hearing success.\*

\* Data on file



The information in this document contains general descriptions of the technical options available, which do not always have to be present in individual cases and are subject to change without prior notice.

Trademarks and trade names are those of their respective owners.

### **Legal Manufacturer**

Signia GmbH  
Henri-Dunant-Strasse 100  
91058 Erlangen  
Germany

Order No. XXX-99C1-7600 | Printed in Germany  
© 03.2020 Signia GmbH

Find us on:

[signia-hearing.com](https://www.signia-hearing.com)



[signiahearing](https://www.facebook.com/signiahearing)



[signiahearing](https://www.youtube.com/signiahearing)



[@signiahearing](https://www.instagram.com/signiahearing)